

MCT Brattberg RGB/RGG System

Data Sheet



NEMA TYPE 3R	NEMA TYPE 4X	NEMA TYPE 12	
IP65	IP66	IP67	IP68



RGB/RGG system consists of a frame, Lycron insert blocks (Synthetic Polymer), stayplates, and a compression unit.

The frame is casted or bolted to a structure and packed with insert blocks suited for each cable and pipe dimension.

The standard frame is made of an angle bar 60x60x6 mm in mild steel, stainless steel or aluminium.

The mild steel frames are supplied with two types of surface finish, primer or galvanized. The internal width is always 120.5 ± 0.5 mm.

Putting safety first

Performance.	Type.	Standard.
Reaction to fire:	Class E	EN 13501-1
Resistance to fire:	EI 60-240 & E 60-240	EN 13501-2
ATEX / IECEx:	Certified	IEC 60079-0:2012,60079-31:2014,60079-7:2015, All:2013. -60.c to +70.c
Nema 250:	3R; 4X; 12	Nema 250-2014 1 st E
IP Rating:	IP65; IP66; IP67; IP68 2 meters.	IEC 60529
Data.		
Trade name:	MCT Brattberg RGB/RGG multi cable/pipe transit system	
Variations:	RGB/RGG-1; RGB/RGG-2; RGB/RGG-3; RGB/RGG-4; RGB/RGG-5; RGB/RGG-6; RGB/RGG-7; RGB/RGG-8; RGB/RGG-180; RGB/RGG-240; RGB/RGG-360 and combinations.	
Working temperature:	-60 to +70 degrees C	
Lycron data.		
Oxygen index:	31%	
Heat transfer:	0.15 W/m*K	
Electrical insulation:	> 20 kV AC/mm	
Smoke index:	47.6	
Hardness:	78-88 IRHD	
Lycron chemical compatibility.		
Water:	Excellent	
Submerged in Oil:	Not recommended	
Ozone:	Excellent	
Sea water:	Excellent	
Methanol:	Excellent	
Chlorine:	Good	
Submerged in Diesel:	Not recommended	
Submerged in Gasoline:	Not recommended	
Acid:	Good	

Lycron is halogen free and flame retardant.

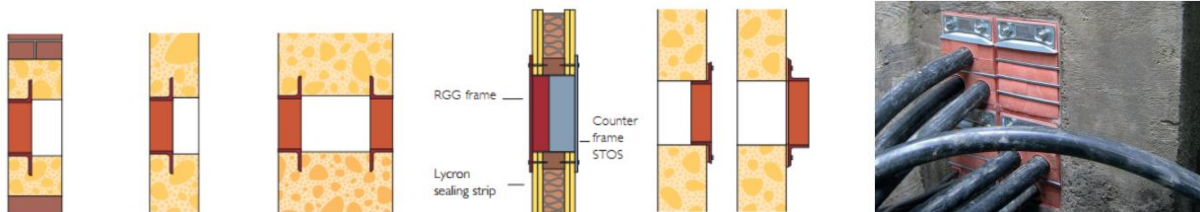

www.mctbrattberg.com

MCT Brattberg AB
SE-371 92 Karlskrona
Sweden
Phone: +46-455 37 52 00
Fax: +46-455 37 52 90
E-mail: info@mctbrattberg.se
Website: www.mctbrattberg.se

MCT Brattberg Ltd
Commerce Street
Carrs Industrial Estate Haslingden
Lancashire BB4 5JT
England
Tel: +44 - 170 624 4890
Fax: +44 - 170 624 4891
E-mail: info@mctbrattberg.co.uk

MCT Brattberg Inc.
P.O. Box 374
Spring Tx 77383
USA
Phone: +1 (281) 355 8191
Fax: +1 (281) 355 8393
E-mail: info@brattberginc.com